

STR. MALE MODULE 2 SOLDER TYPE INSERTS

R694.251.022

3 MM FOR PCB

Series : MCC2

2 Coax Position AB/1B

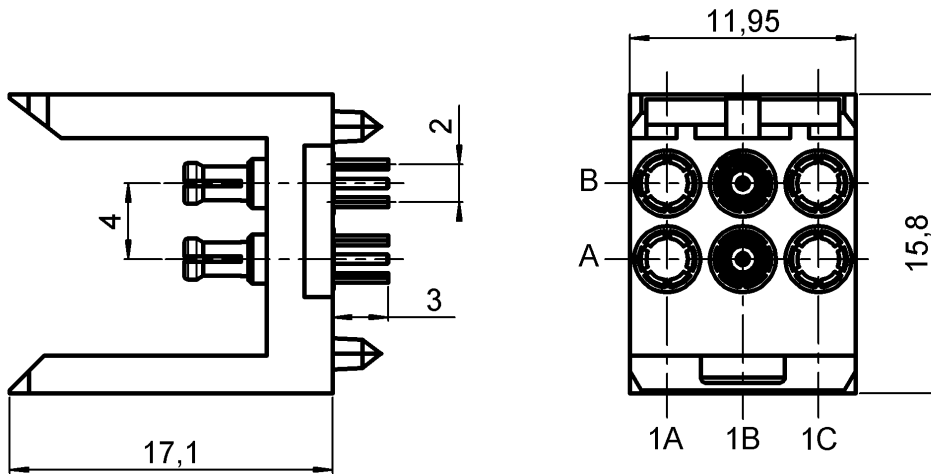

Connectors' packaging

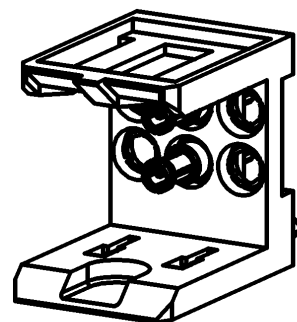
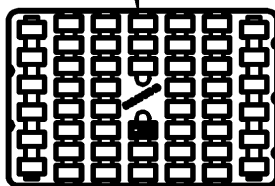
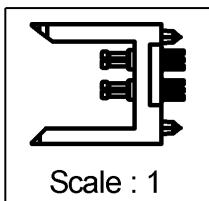

All dimensions are in mm.

| COMPONENTS | MATERIALS | PLATING (µm) |
|----------------|------------------------|--------------|
| BODY | BRONZE | NPGR |
| CENTER CONTACT | BRASS | NPGR |
| OUTER CONTACT | BRONZE | NPGR |
| INSULATOR | PTFE | |
| GASKET | - | |
| OTHERS PARTS | LIQUID CRISTAL POLYMER | |
| - | - | - |
| - | - | - |

Issue : 0624 C

In the effort to improve our products, we reserve the right to make changes judged to be necessary.



STR. MALE MODULE 2 SOLDER TYPE INSERTS

R694.251.022

3 MM FOR PCB

Series : MCC2

PACKAGING

SPECIFICATION

| Standard | Unit | Other |
|-----------|-------------------|-------------------|
| 50 | 'W' option | Contact us |

ELECTRICAL CHARACTERISTICS

| | | |
|---------------------------------|----------------------|--------------------------------|
| Impedance | 50 | Ω |
| Frequency | 0-6 | GHz |
| VSWR | 1.12 + 0,0000 | x F(GHz) Maxi |
| Insertion loss | 0.2 | $\sqrt{F}(\text{GHz})$ dB Maxi |
| RF leakage | - (| - F(GHz)) dB Maxi |
| Voltage rating | 500 | Veff Maxi |
| Dielectric withstanding voltage | 750 | Veff mini |
| Insulation resistance | 5000 | M Ω mini |

ENVIRONMENTAL

| | | |
|-----------------------|-----------------|--------------------|
| Operating temperature | -25/+125 | $^{\circ}\text{C}$ |
| Hermetic seal | NA | Atm.cm3/s |
| Panel leakage | NA | |

OTHER CHARACTERISTICS

Assembly instruction

Others :

VSWR=1.12 optimized between DC to 3GHz

MECHANICAL CHARACTERISTICS

| | | |
|----------------------------|---------------|-------------|
| Center contact retention | | |
| Axial force – Mating end | 6 | N mini |
| Axial force – Opposite end | 6 | N mini |
| Torque | NA | N.cm mini |
| Recommended torque | | |
| Mating | NA | N.cm |
| Panel nut | NA | N.cm |
| Mating life | 500 | Cycles mini |
| Weight | 1,4190 | g |

Issue : 0624 C

In the effort to improve our products, we reserve the right to make changes judged to be necessary.



STR. MALE MODULE 2 SOLDER TYPE INSERTS

R694.251.022

3 MM FOR PCB

Series : MCC2

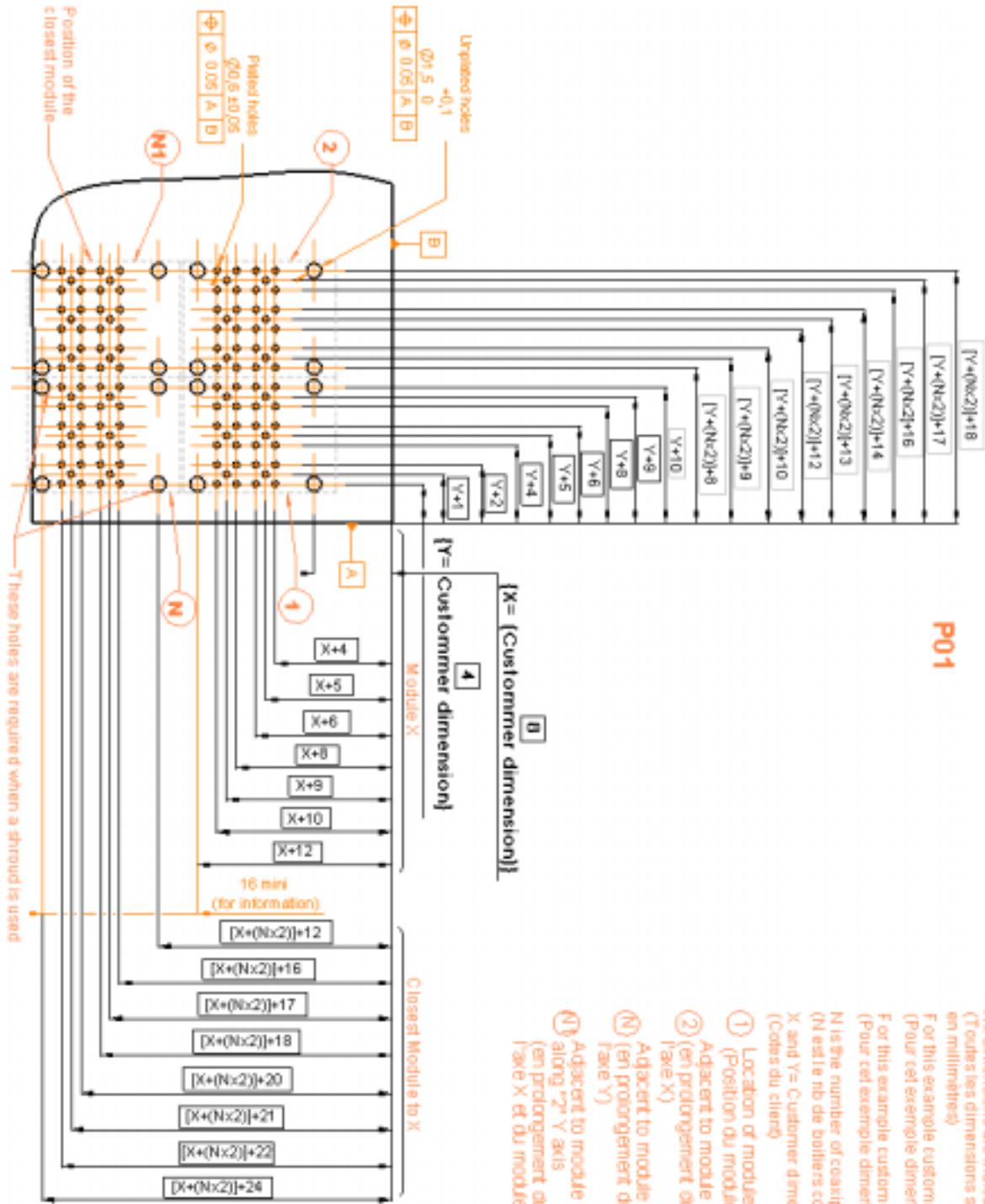

P01

- All dimensions are indicated in millimetres (Toutes les dimensions sont indiquées en millimètres)
- For this example customer dimension X=8mm (Pour cet exemple dimension du client X=8mm)
- For this example customer dimension Y=4mm (Pour cet exemple dimension du client Y=4mm)
- N is the number of coaxpack 2 (N est le nb de butlers coaxpack 2)
- X and Y= Customer dimensions (Codes du client)
- ① Location of module "1" (Position du module "1")
 - ② Adjacent to module "1" along X axis (en prolongement du module "1" selon l'axe X)
 - ③ Adjacent to module "1" along Y axis (en prolongement du module "1" selon l'axe Y)
 - ④ Adjacent to module "N" along X axis and along "2" Y axis (en prolongement du module "N" selon l'axe X et du module 2 selon l'axe Y)

Issue : 0624 C

In the effort to improve our products, we reserve the right to make changes judged to be necessary.



STR. MALE MODULE 2 SOLDER TYPE INSERTS

R694.251.022

3 MM FOR PCB

Series : MCC2

- Place the coax connector(s) on the PCB

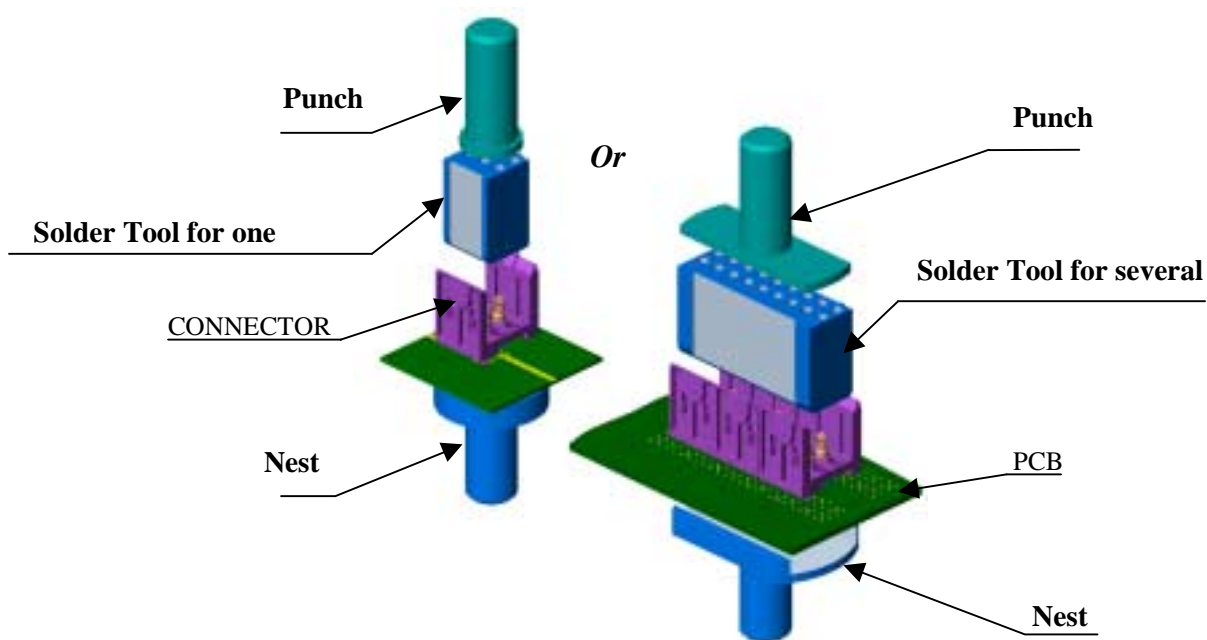

- Place correctly the PCB between the punch and the nest of the press.
- In case of multiple housing configuration , use a punch and a nest large enough to cover all the housings.
- Ensure solder legs are properly aligned with the holes before press-mounting.
- Press on the housing(s) with the punch until the complete insertion of the fixing stud into the PCB.

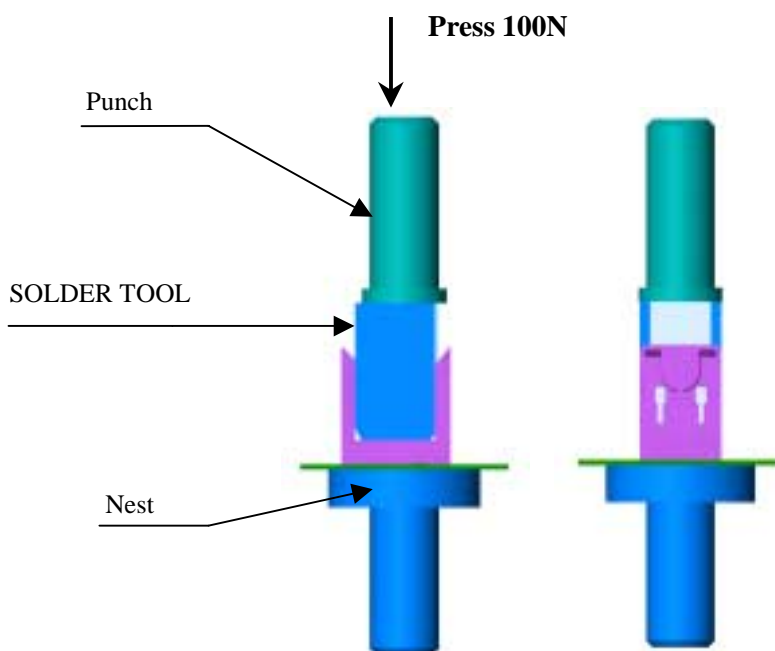

Issue : 0624 C

In the effort to improve our products, we reserve the right to make changes judged to be necessary.



STR. MALE MODULE 2 SOLDER TYPE INSERTS
3 MM FOR PCB

R694.251.022

Series : MCC2

- After the insertion of the connectors on the printed circuit , leave the solder tool inserted in position.
- Solder the legs on board

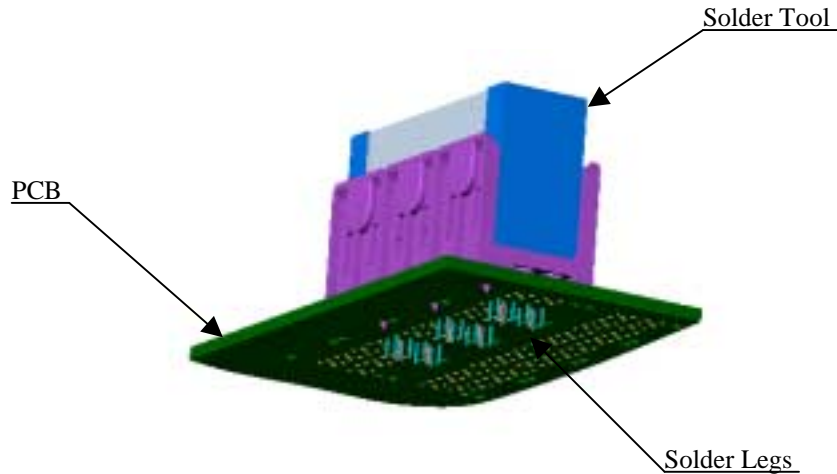

- After the solder legs have been soldered , using an appropriate soldering process , remove the solder tool.

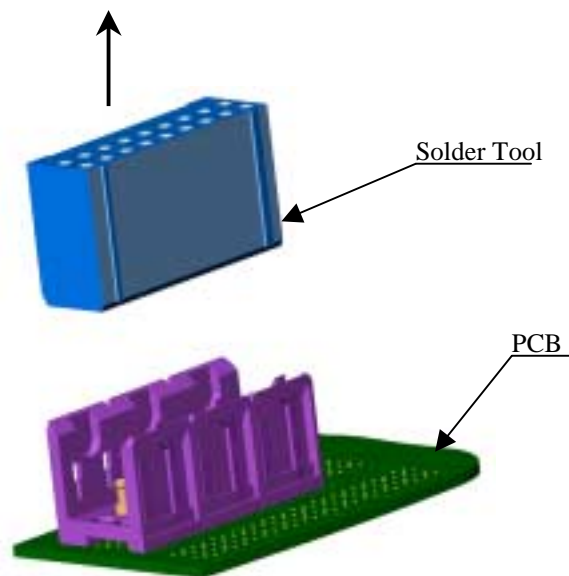

Radiall do not recommend to use more than 3 modules on the same motherboard and can't be held liable of any connection defect when more than 3 modules are implemented on the board.

Issue : 0624 C

In the effort to improve our products, we reserve the right to make changes judged to be necessary.

